



Temporary traffic arrangements at South Road intersection with Torrens Road from Monday 19 December 2016 to late May 2017



Artist Impression: Torrens Road bridge looking south

As part of the Torrens Road to River Torrens (T2T) Project, traffic will be switched on to the new north bound surface road on South Road between Torrens Road and Tait Street.

These temporary changes are required to commence construction of the Torrens Road bridge.

New traffic arrangements

From 6am Monday 19 December 2016, after the traffic switch, the following new traffic arrangements will be in place.

- Right turn movements will not be permitted at the South Road intersection with Torrens Road.
- South Road north bound (towards Regency Park) – two through lanes and a left slip lane (to turn left into Torrens Road) will be maintained.
- South Road south bound (towards Darlington) – two through lanes and a left turn only lane (to turn left into Torrens Road) will be maintained.
- Torrens Road in each direction (west bound towards the beach and east bound towards the city) – two through lanes and left turn slip lanes (to turn left into South Road) will be maintained.
- Temporary, signalised u-turns will be installed near Tait Street and at Dartmouth Street.
- Left turn movements in and out of Ellen Street will be maintained. Right turn movements in and out of Ellen Street at South Road will not be permitted. This is a permanent change to this junction.
- Dartmouth Street will be temporarily closed at South Road from 7pm Wednesday 14 December 2016 to late May 2017.

Please refer to map and full details of the changed traffic arrangements over the page.

Temporary traffic arrangements at South Road intersection with Torrens Road from Monday 19 December 2016 to late May 2017

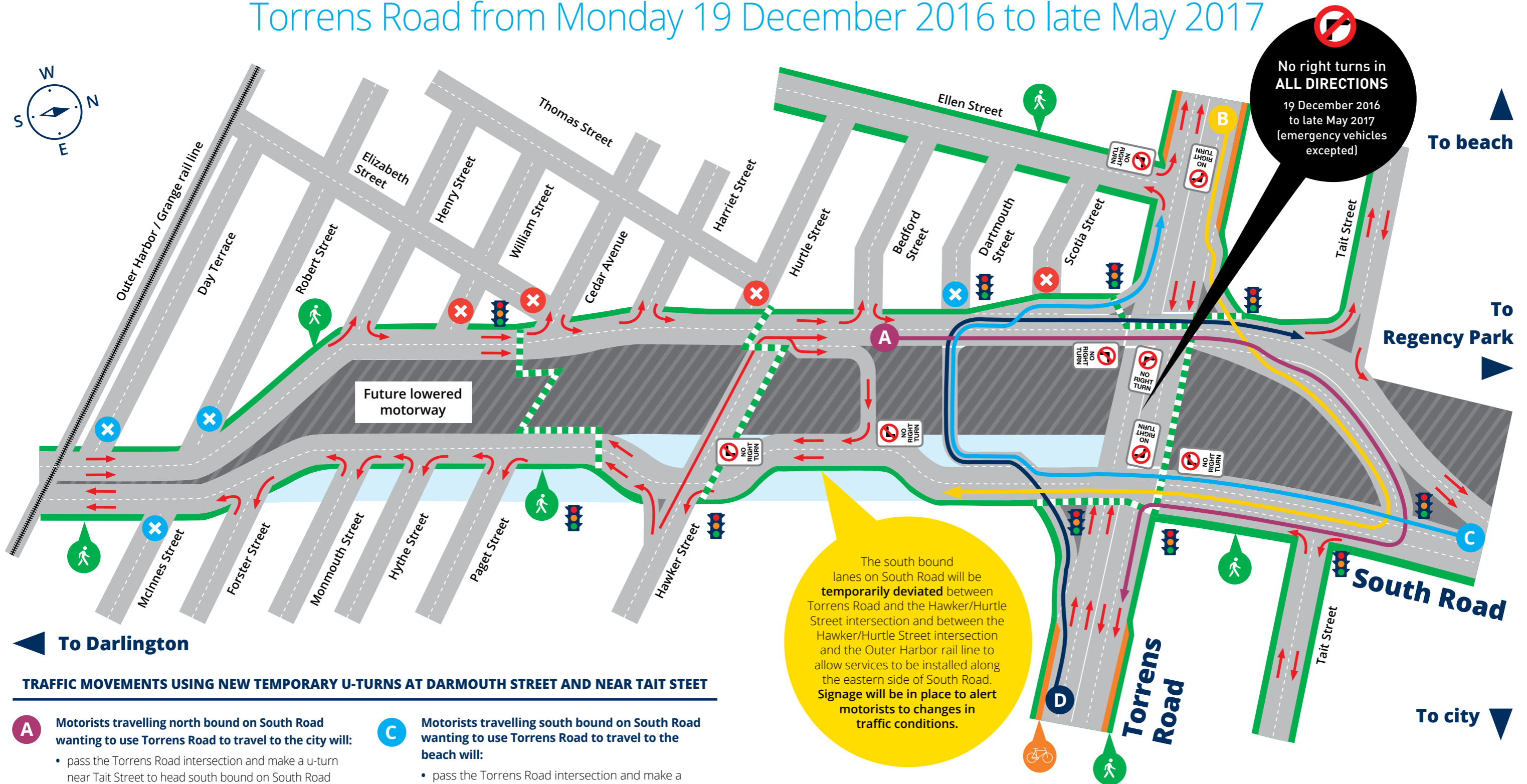

TRAFFIC MOVEMENTS USING NEW TEMPORARY U-TURNS AT DARTMOUTH STREET AND NEAR TAIT STREET

- A** Motorists travelling north bound on South Road wanting to use Torrens Road to travel to the city will:
 - pass the Torrens Road intersection and make a u-turn near Tait Street to head south bound on South Road and turn left into Torrens Road to head east bound towards the city.
- B** Motorists travelling east bound on Torrens Road wanting to use South Road to travel to Darlington will:
 - turn left into South Road at the Torrens Road intersection and make a u-turn near Tait Street to head south bound on South Road.
- C** Motorists travelling south bound on South Road wanting to use Torrens Road to travel to the beach will:
 - pass the Torrens Road intersection and make a u-turn at Dartmouth Street to head north bound on South Road and turn left into Torrens Road to head west bound towards the beach.
- D** Motorists travelling west bound on Torrens Road wanting to use South Road to travel to Regency Park will:
 - turn left into South Road at the Torrens Road intersection and make a u-turn at Dartmouth Street to head north bound on South Road.

MAP LEGEND

	Pedestrian footpaths		Permitted traffic turn movements		Future lowered motorway
	Pedestrian crossing		Permanent road closure		Traffic signals
	Dedicated on-road cyclist route		Temporary road closure		Temporary lane closure

Pedestrians and cyclists

Pedestrian access at the South Road intersection with Torrens Road will be maintained on both sides of South Road and on the northern side only of Torrens Road. Pedestrian crossings will be maintained near Cedar Avenue and Hawker/Hurtle Streets (refer to map pages 2 - 3).

There are on-road dedicated bicycle lanes on both sides of Torrens Road. Cyclists can use traffic lanes when crossing the South Road intersection with Torrens Road or dismount and cross at the available pedestrian crossings.

Bus users

Following the traffic switch, bus routes will follow the temporary, signalised u-turn being installed at Tait Street. There will be no changes to bus stops or timetables.

For more information on bus timetables and services please visit:
www.adelaidemetro.com.au

Important reminder: South Road businesses

Please note that while works are being undertaken to construct the Torrens Road bridge, businesses located on the eastern side of South Road will remain **OPEN FOR BUSINESS**. We encourage you to support them with your patronage.

The T2T Alliance will ensure that access to these businesses is maintained and that disruptions are minimised as much as possible.

Torrens Road bridge construction milestones

The Torrens Road bridge will be constructed in two halves between January 2017 to August 2017.

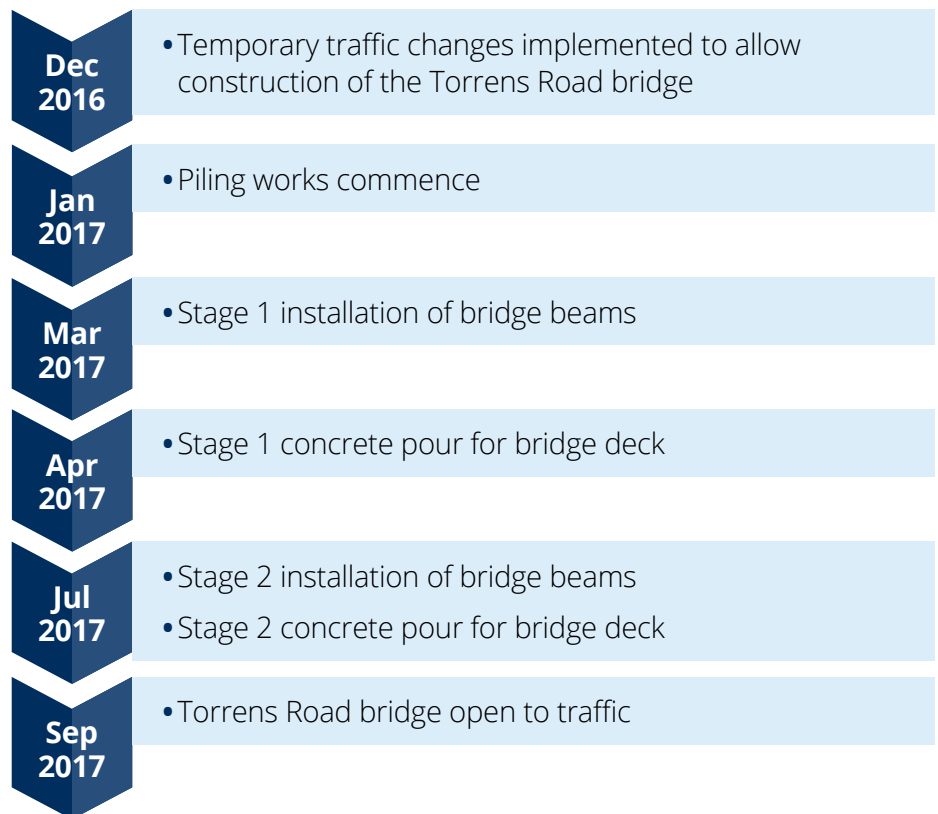

For more information and enquiries

Visit: www.t2talliance.com.au for the latest traffic information including alternative routes for heavy and light vehicles and local traffic arrangements.

Email: enquiries@t2talliance.com.au

Call: 1300 794 899

For real time delay information, please visit: www.addinsight.com.au and download the app.

